

Murma Lintel – Installation Guide

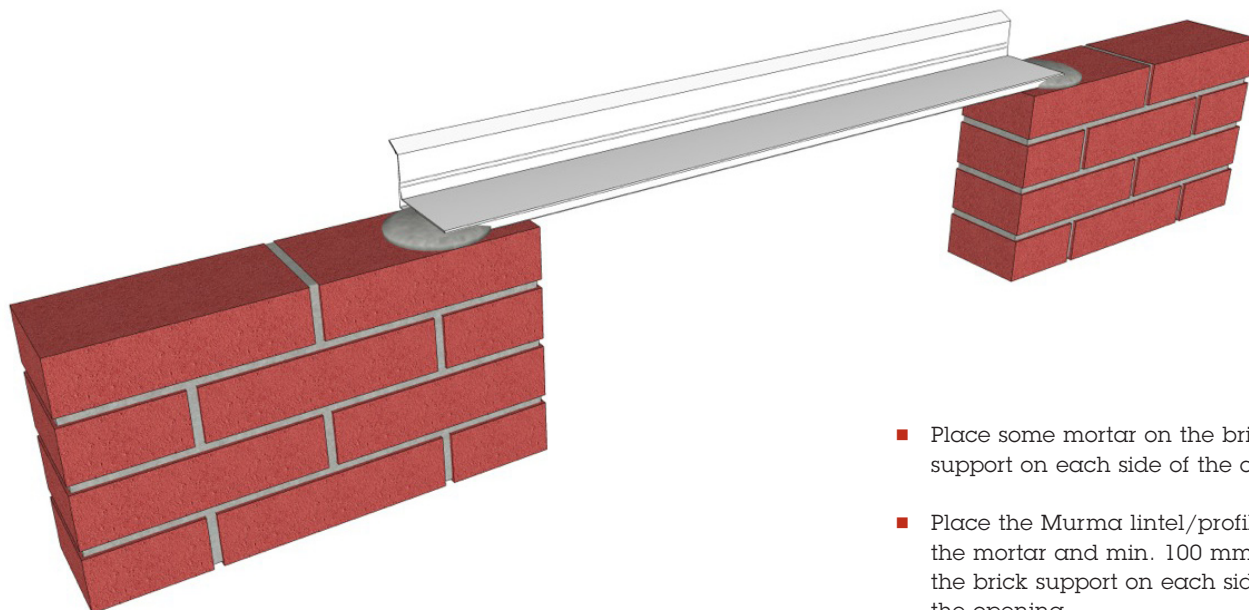

- Place some mortar on the brick support on each side of the opening
- Place the Murma lintel/profile in the mortar and min. 100 mm on the brick support on each side of the opening

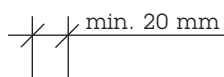

- The lintel /profile shall be withdrawn ca 15 mm from the masonry surface

- Place the first course dry on the lintel/profile with mortar in the butt joint (vertical joint)

- Put some mortar with a distance of 0,5 m from each other

- Place the ladder formed stainless reinforcement in the mortar and push it gently down in the mortar

- The ladder formed reinforcement shall be placed with 3 crosspins in the brick support on each side

- Continue the bricklaying with another course over the opening

- If the bricklaying is done during a very warm period, it's important to wet the bricks that will be used in the beam

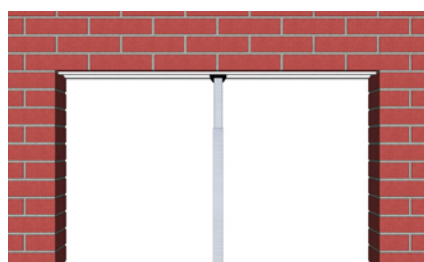

Place a supporting post c/c 1 m under the lintel/profile until the brickwork is hardening.

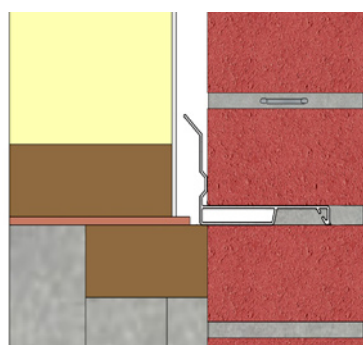

The backside of the lintel is 20 mm, therefore there must be enough space between the brickwall and the supporting wall, see fig above.

Note!

When dimensioning the wall opening height it must be considered, that the rear edge of the lintel projects 13 mm down into the opening.



Murma Byggmaterial AB

Askims Verkstadsväg 14 ■ SE-436 34 Askim ■ Sweden
 Phone: +46 31 99 20 45 ■ Mobile: +46 70 854 11 28
 info@murma.se ■ www.murma.se